

JEEP S.A.S FRANCE

1945

PAR DARK VADOR

(SUR BASE DE TONI  
MAURICIO)

ECH DE  
BASE:  
1/17

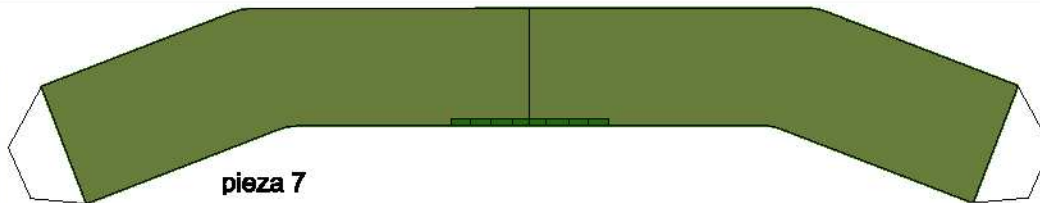

pieza 7



pieza 9 bis



pieza 9

pegar en pieza 8

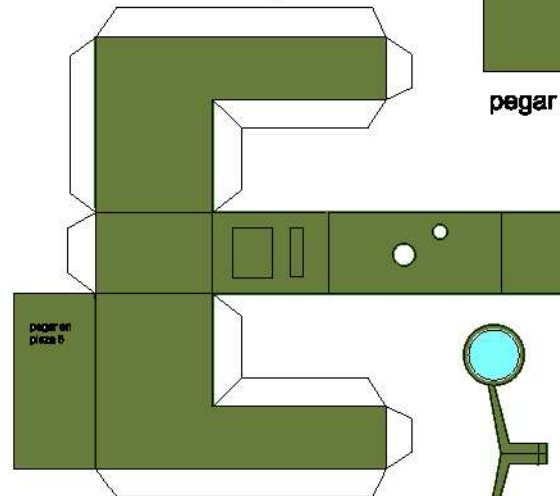

pieza 8

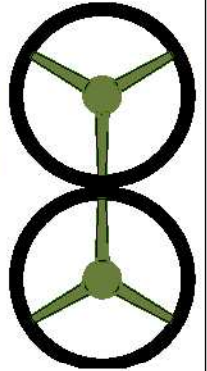
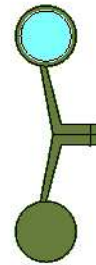

hacer una división  
vertical al medio  
o bien sustituir por  
pallito de dientes

BASE JEEP PIEZA 1



pegar  
pieza 6

pedales



pegar pieza 7

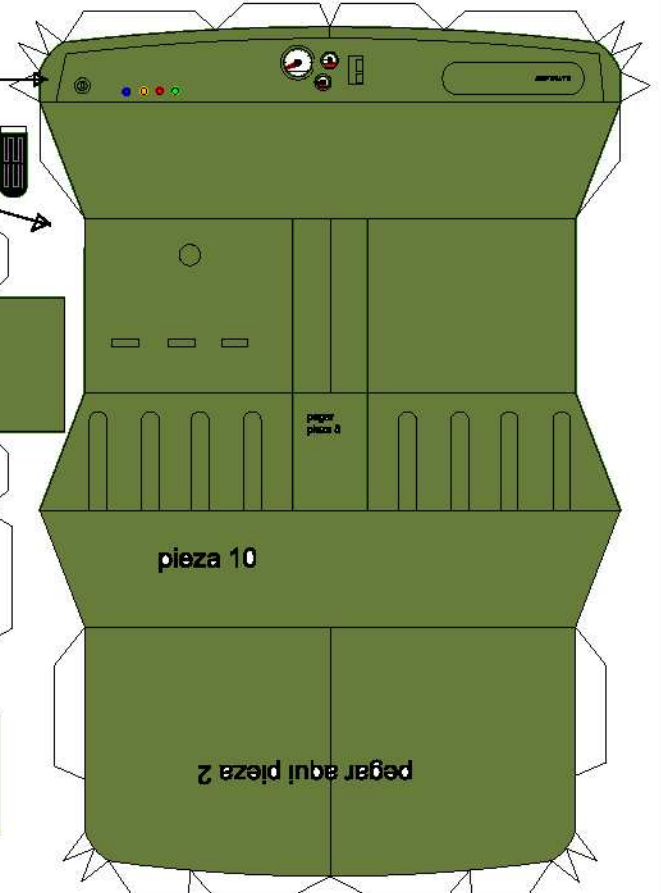

pieza 10

pegar aquí pieza 2

pegar pieza 7





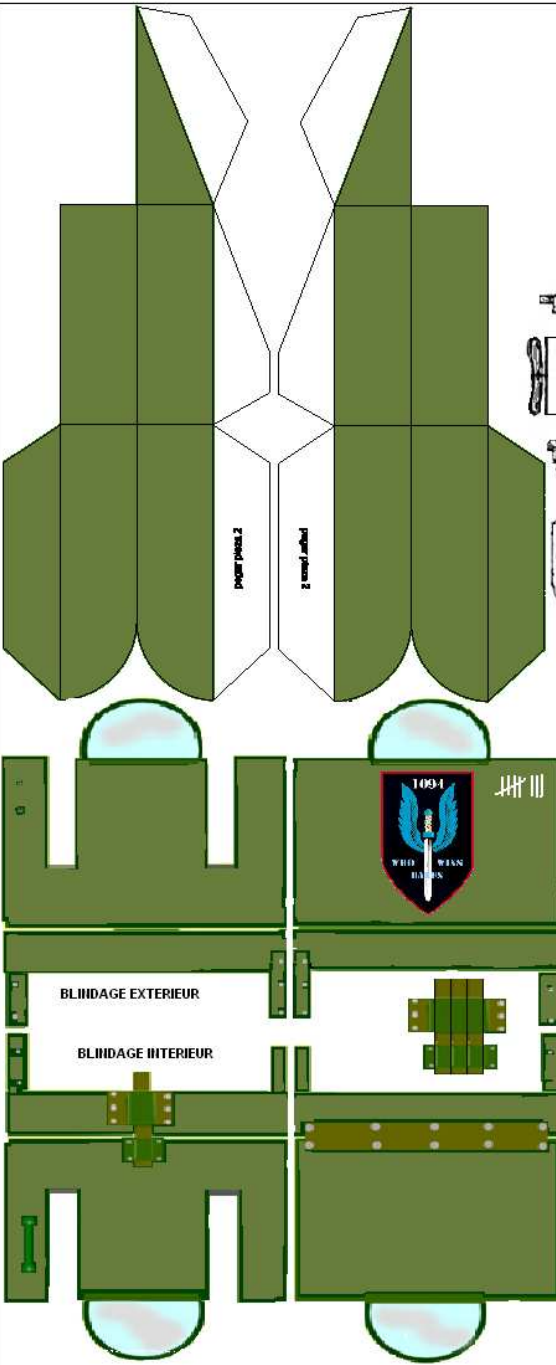
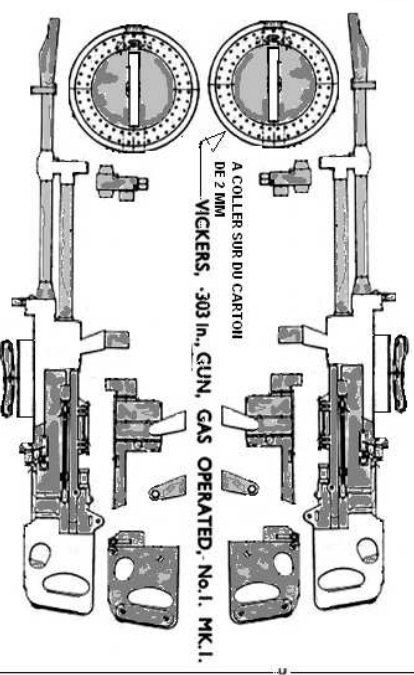
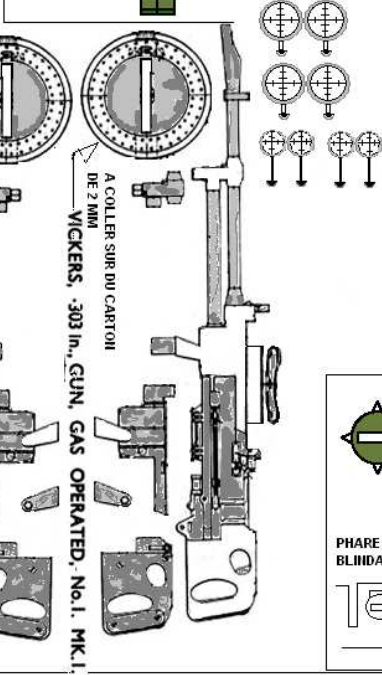
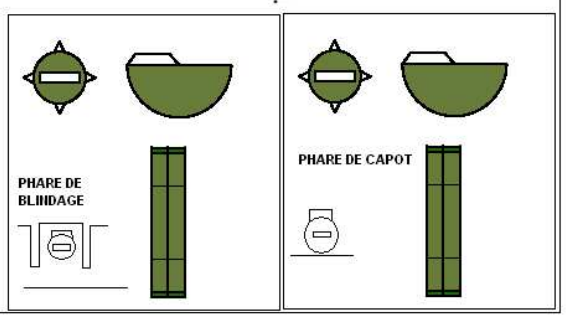
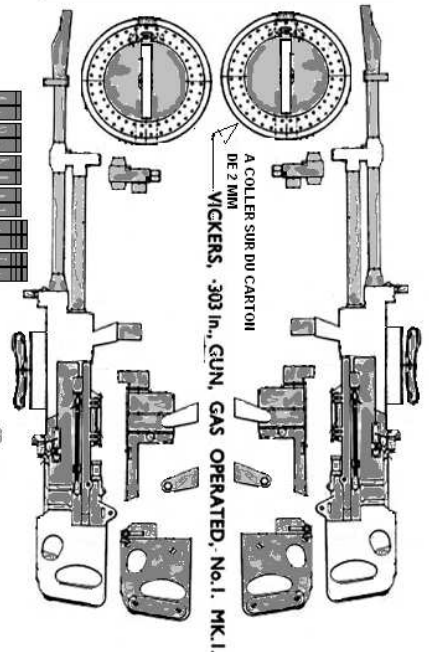
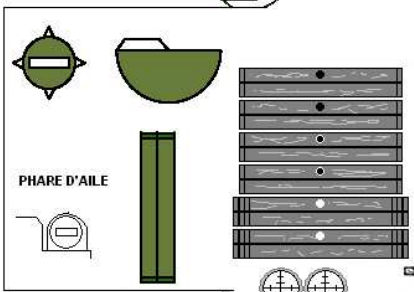
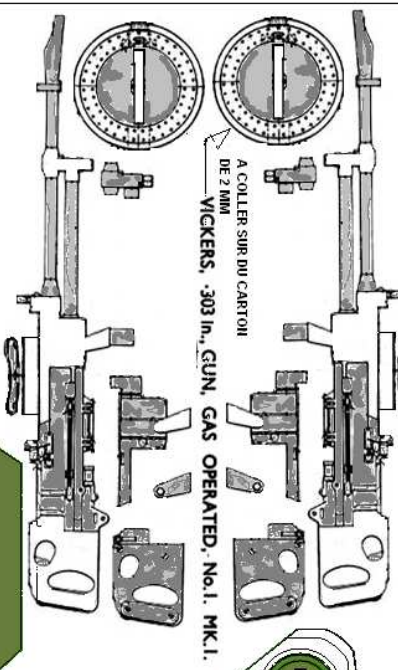
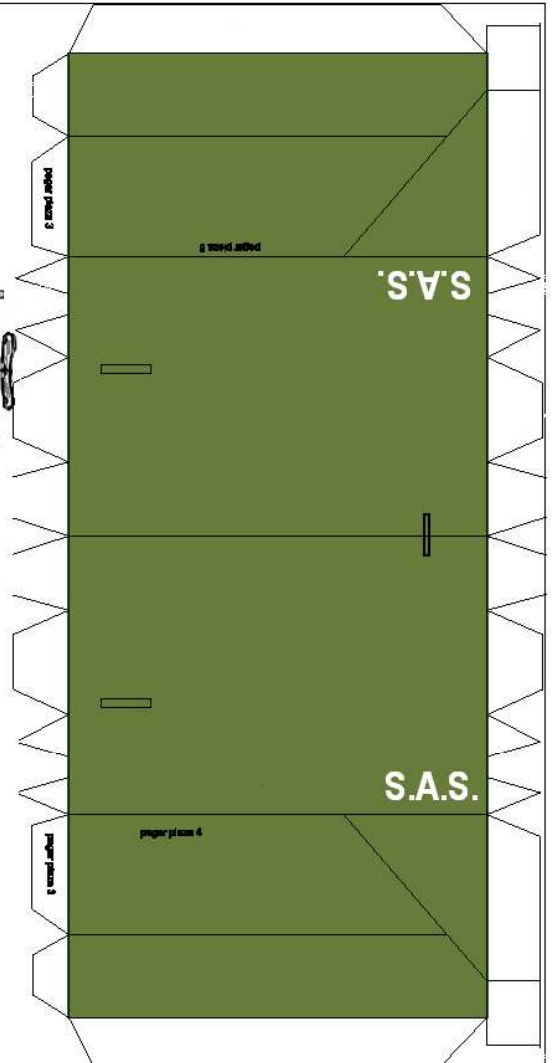

piezas 14 y 15,  
pegar por dentro de  
hueco de ruedas  
traseras

pieza 13  
guardabarras interno  
izquierdo

pegar pieza 13

cortar ✂

pegar en el soporte

pieza  
11

pegar  
en base  
1

pegar en el soporte

pegar en el soporte

cortar ✂

pegar pieza 12

pieza 12  
guardabarras interno  
derecho

S.A.S

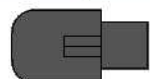

pala, pegar en palillo de  
dientes y colocar en lateral  
según foto



FRK2

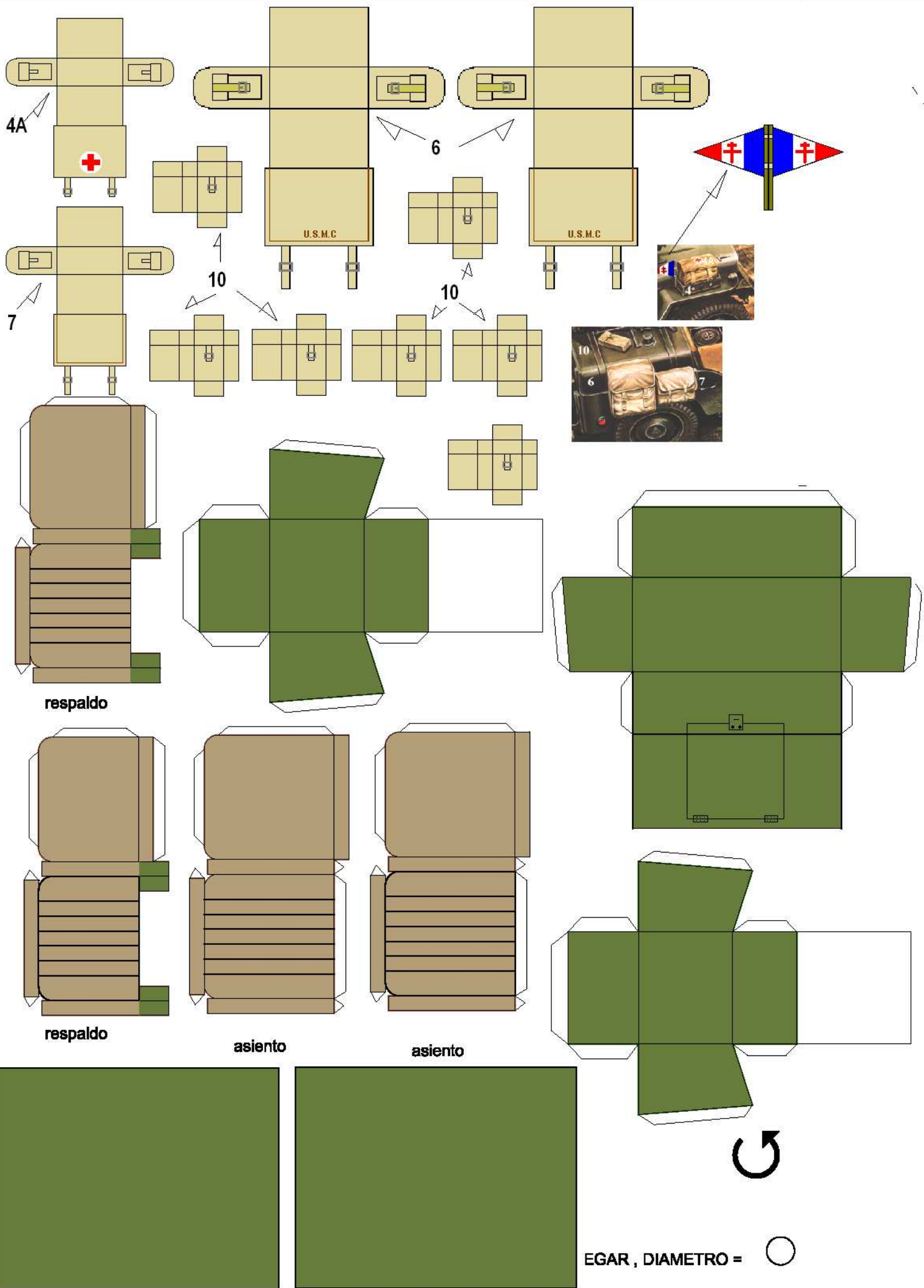

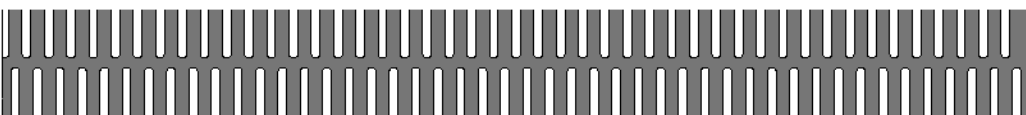
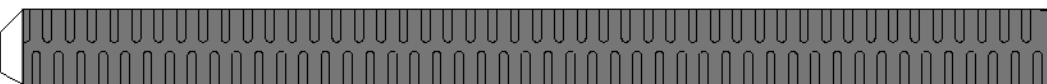
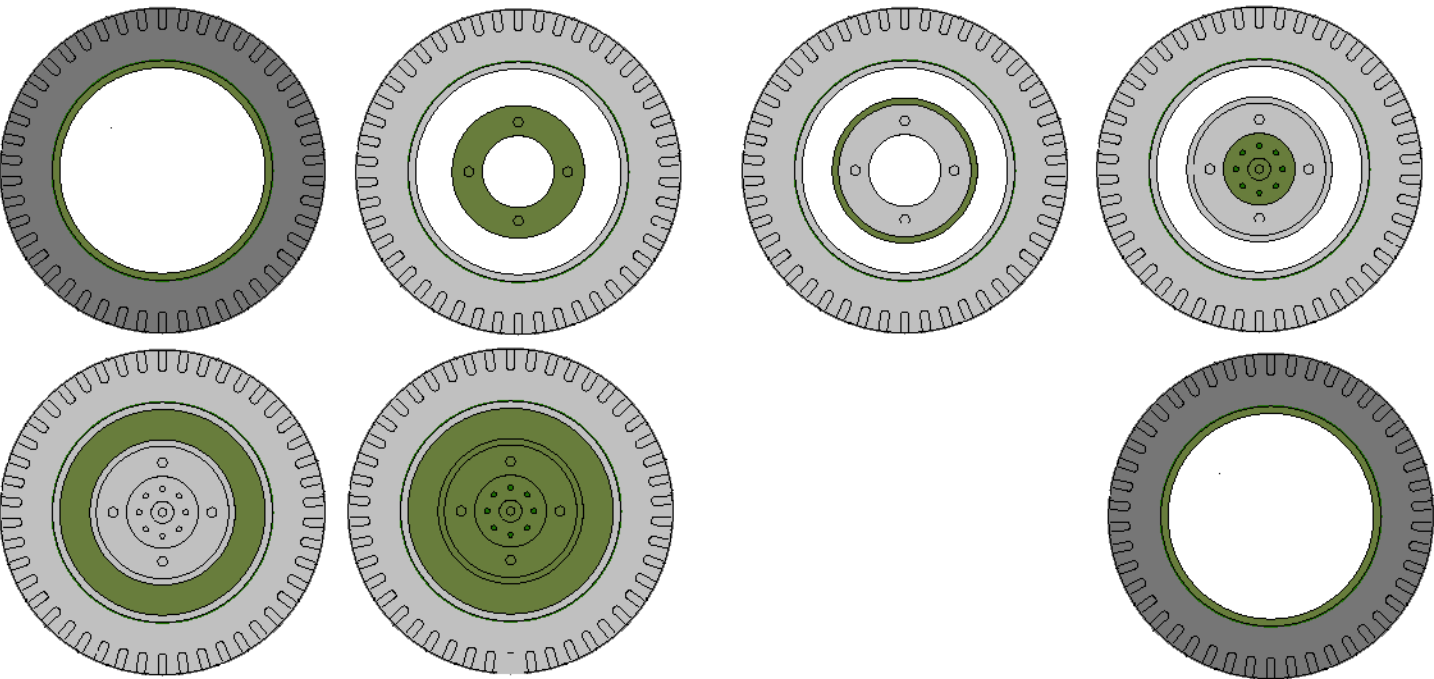
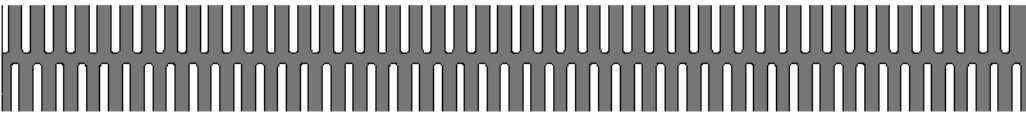
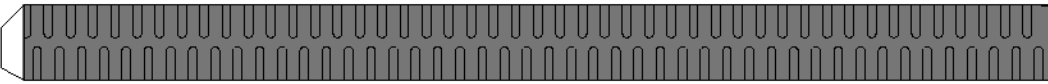
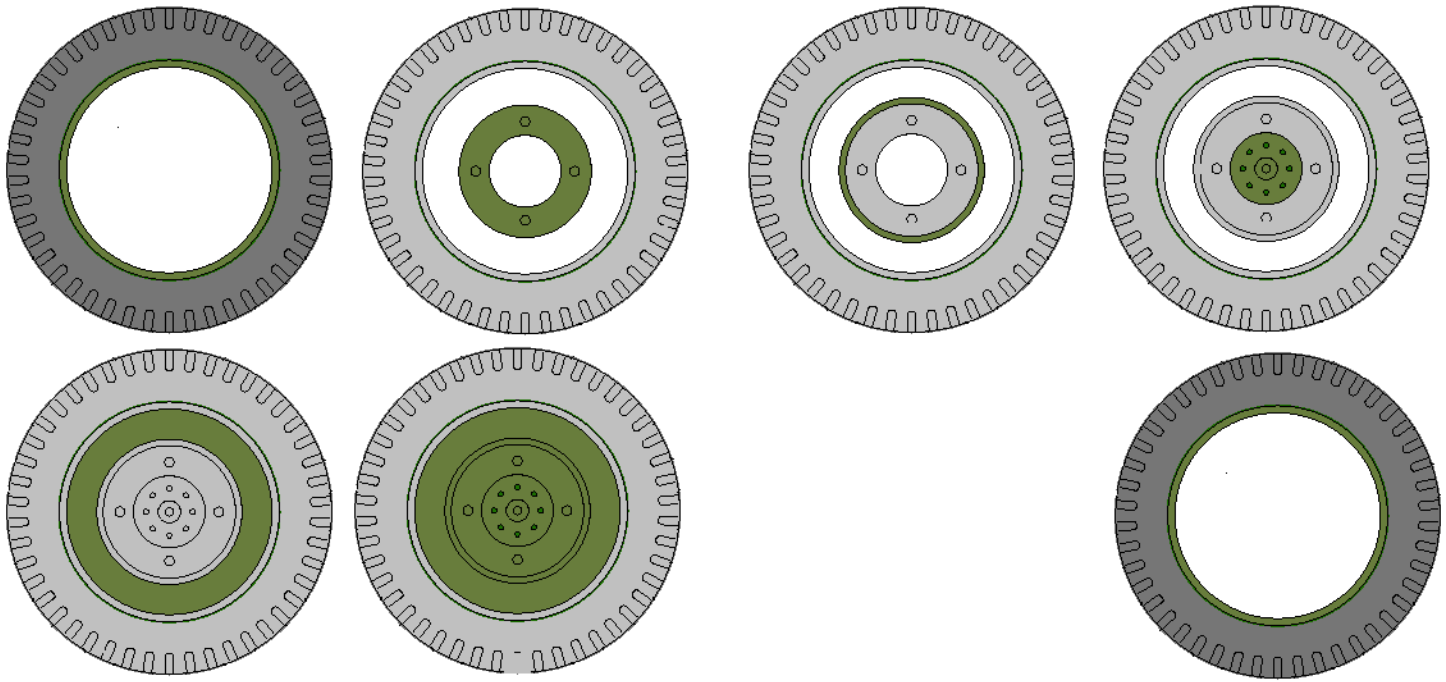





FRANCE

JEEP S.A.S EUROPE 1945

MUNITION DE VICKERS

5

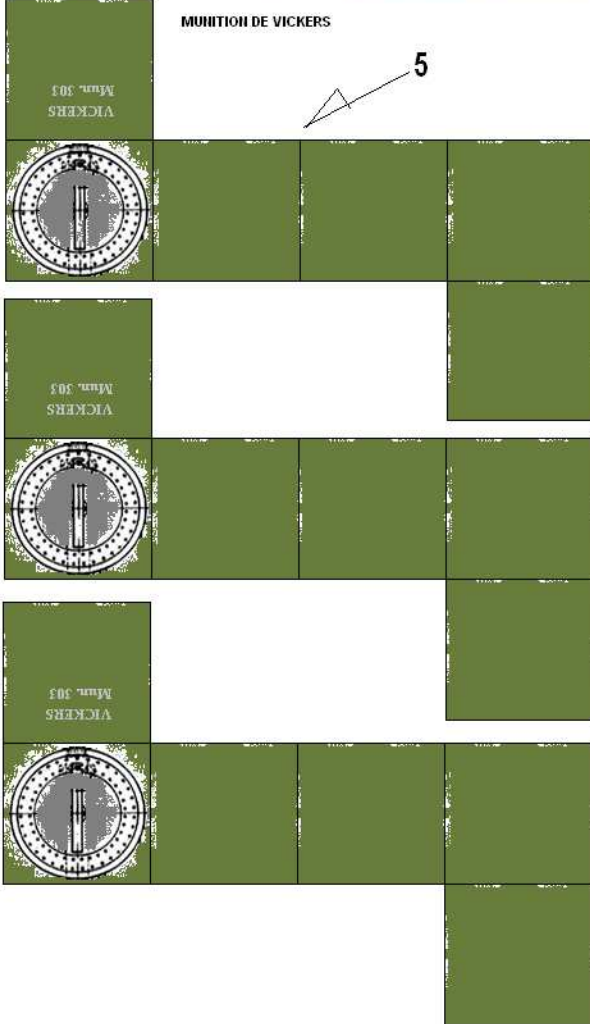

RESERVOIR  
ADDITIONNELS

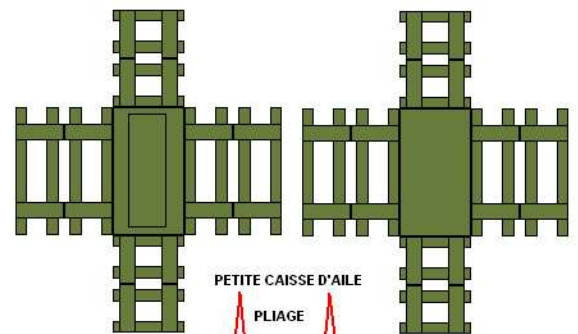
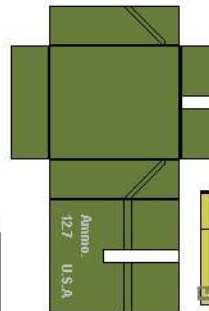
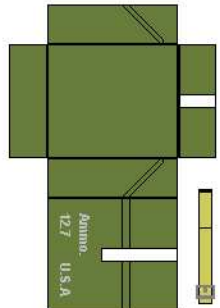
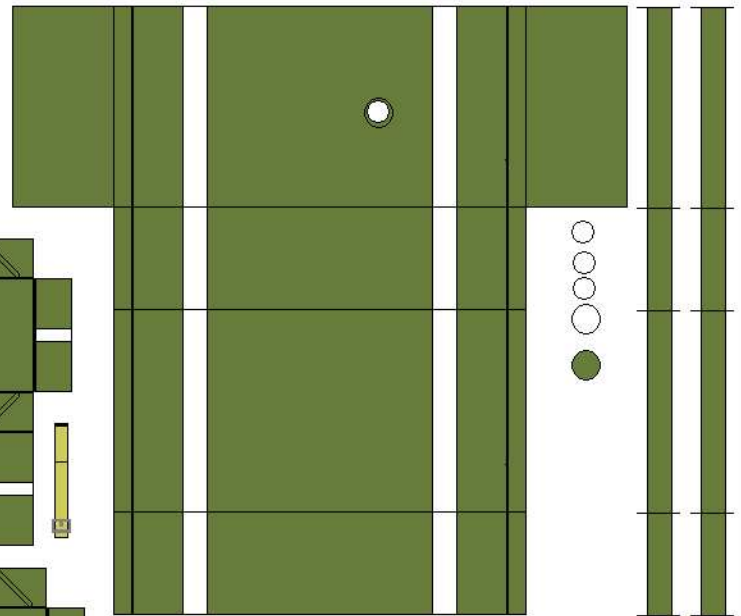
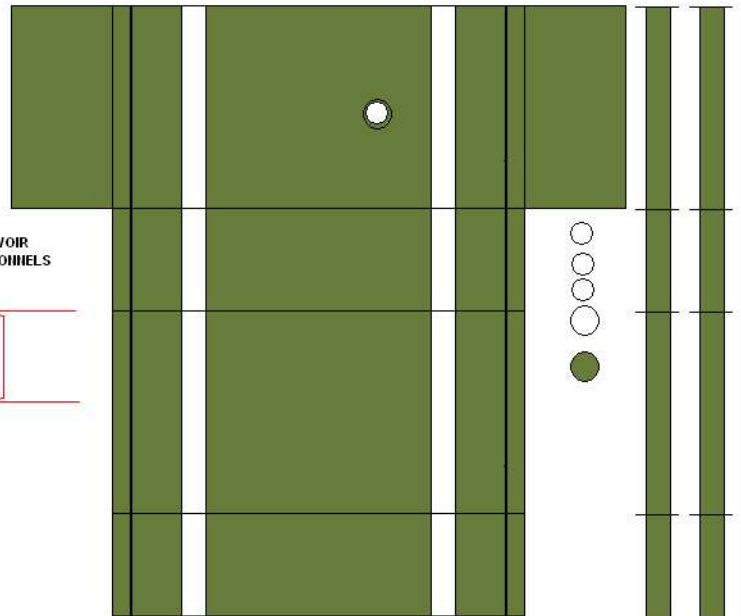
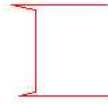

POSITION DE LA ROUE ET DE LA PLAQUE DE BLINDAGE

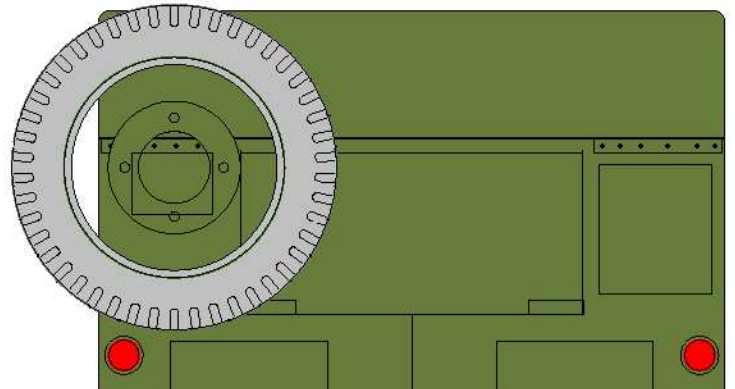

PLAQUE DE BLINDAGE ARRIERE

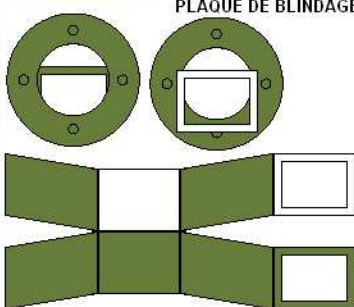
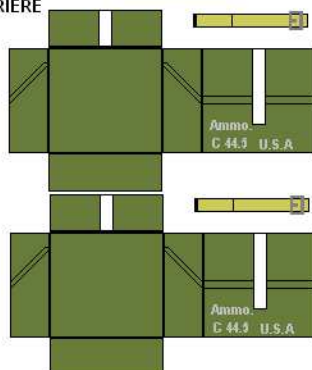

PORTE ROUE

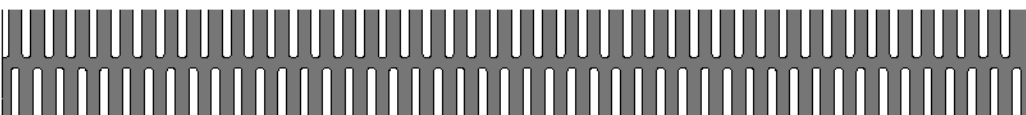
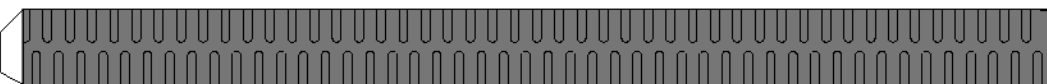
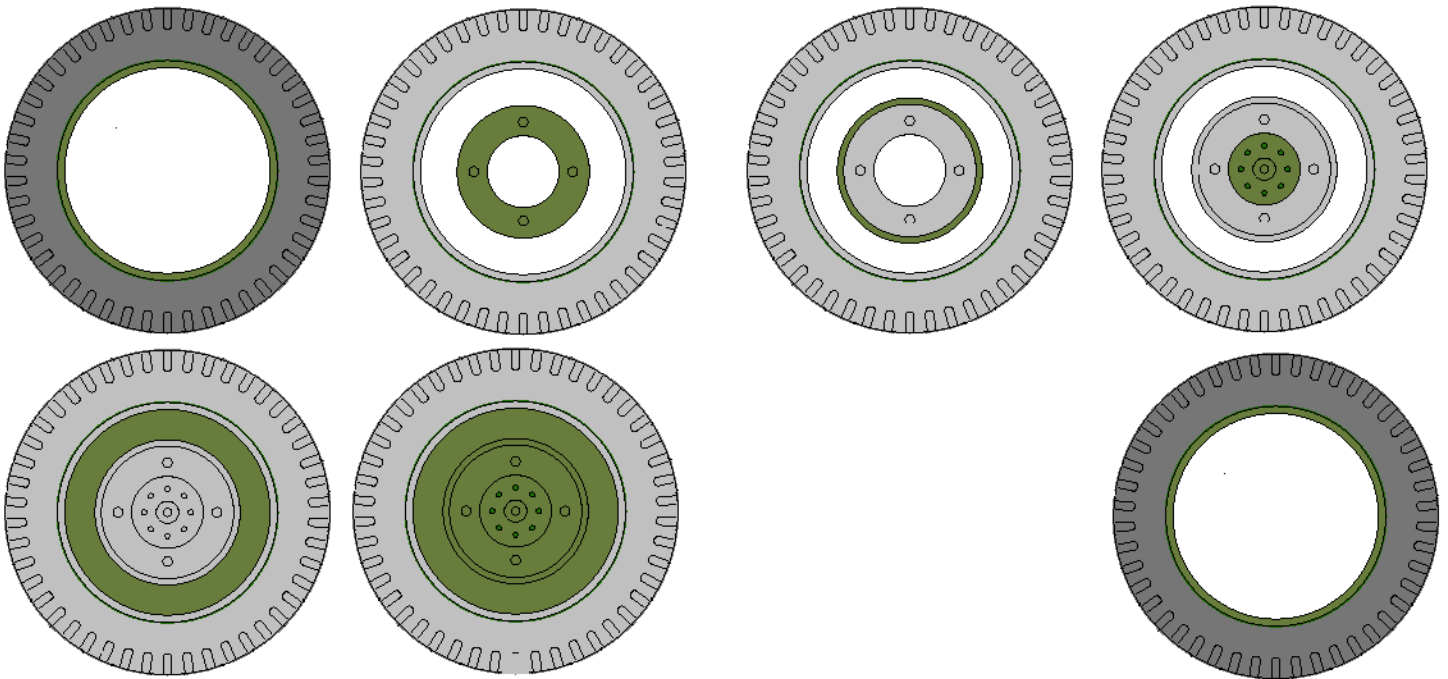
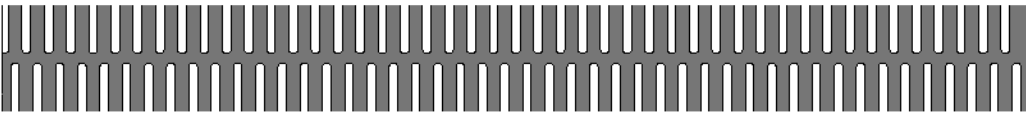
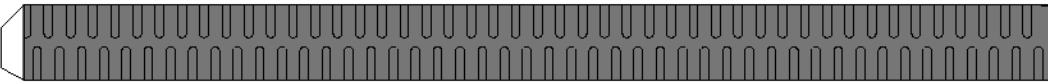
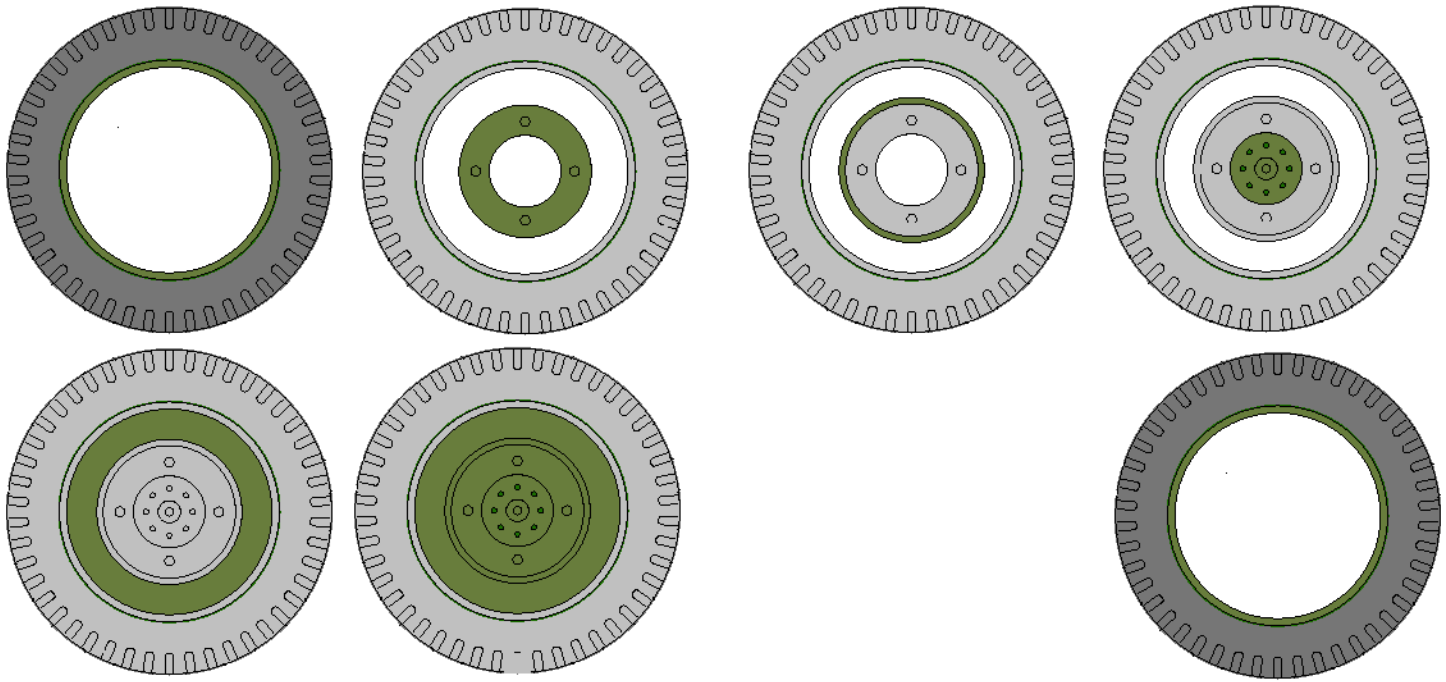



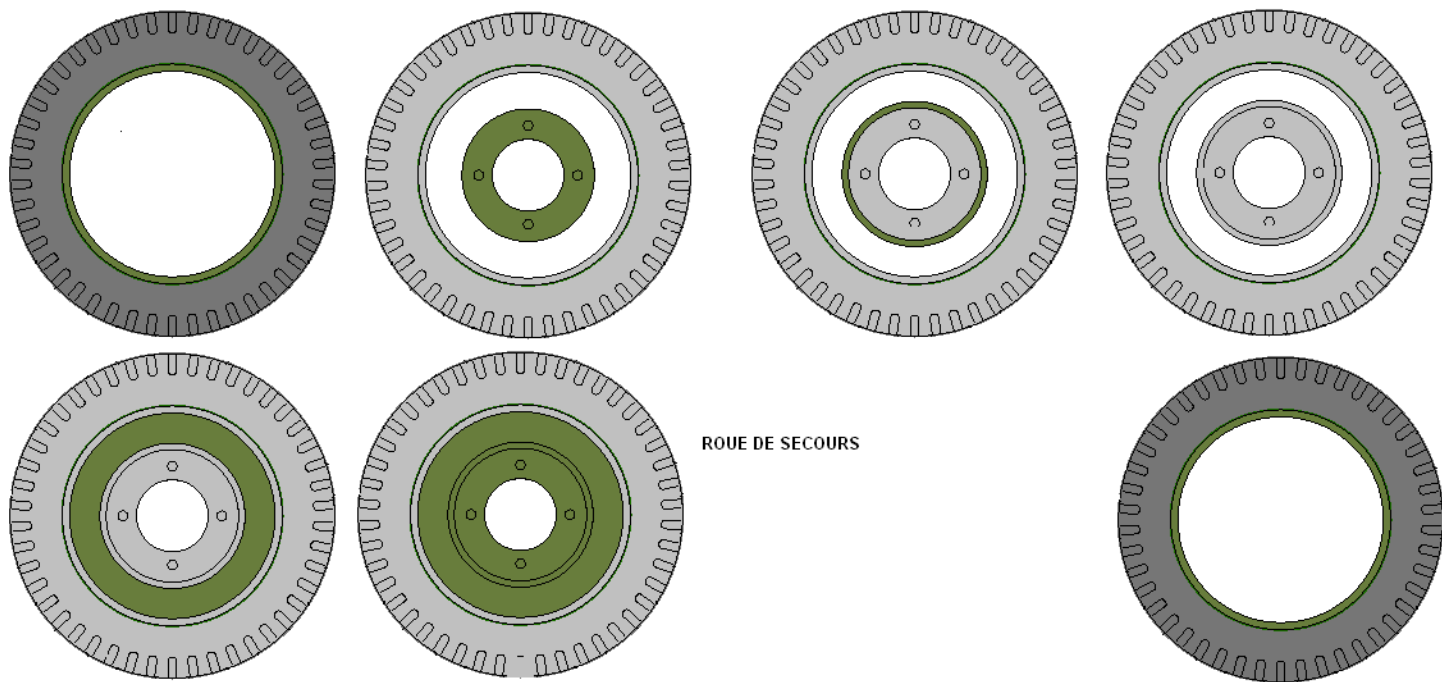

ROUE DE SECOURS

